

AFONICA MPH

Range of booths for motorcycle workbenches

Afonica MPH is the line of soundproof booths designed and built to allow operators in the motorcycle sector to carry out tests and inspections of motorcycles on a roller bench in full compliance with current safety regulations and without disturbing the work environment.

The Afonica MPH soundproof booths are therefore complete with:

- Double swing door with anti-panic opening and viewing window
- Soundproof walls and roof
- Extraction of flue gases
- Internal ventilation

The outdoor version of each model is also available.

On demand:

- Tailor-made creations
- Supply of electrical plant

For info and price:

- Web: www.afonica.it
- E-mail: info@afonica.it
- Phone: (+39) 0445 397 118

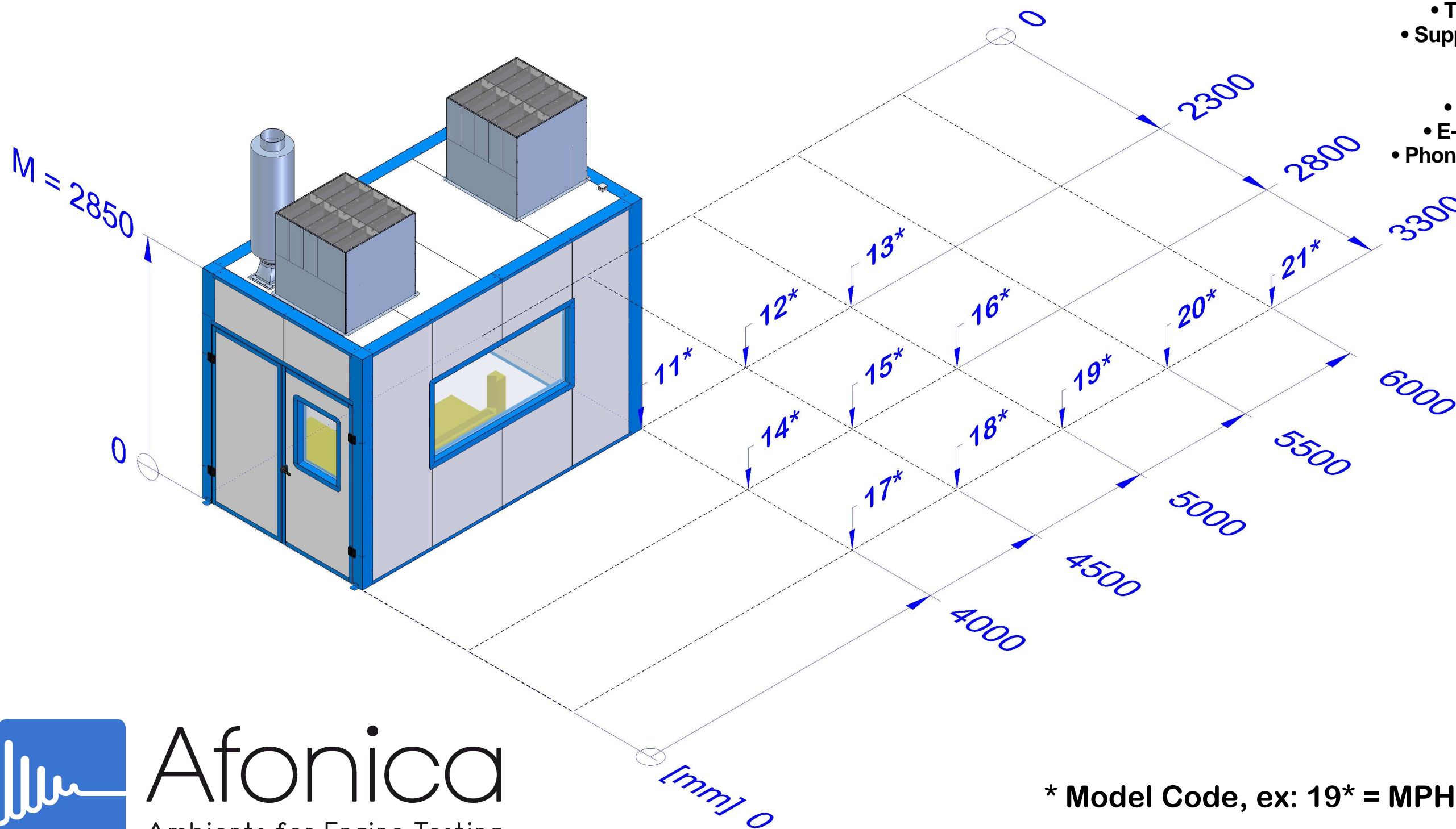

Afonica

Ambients for Engine Testing

* Model Code, ex: 19* = MPH-19

AFONICA MPH RANGE

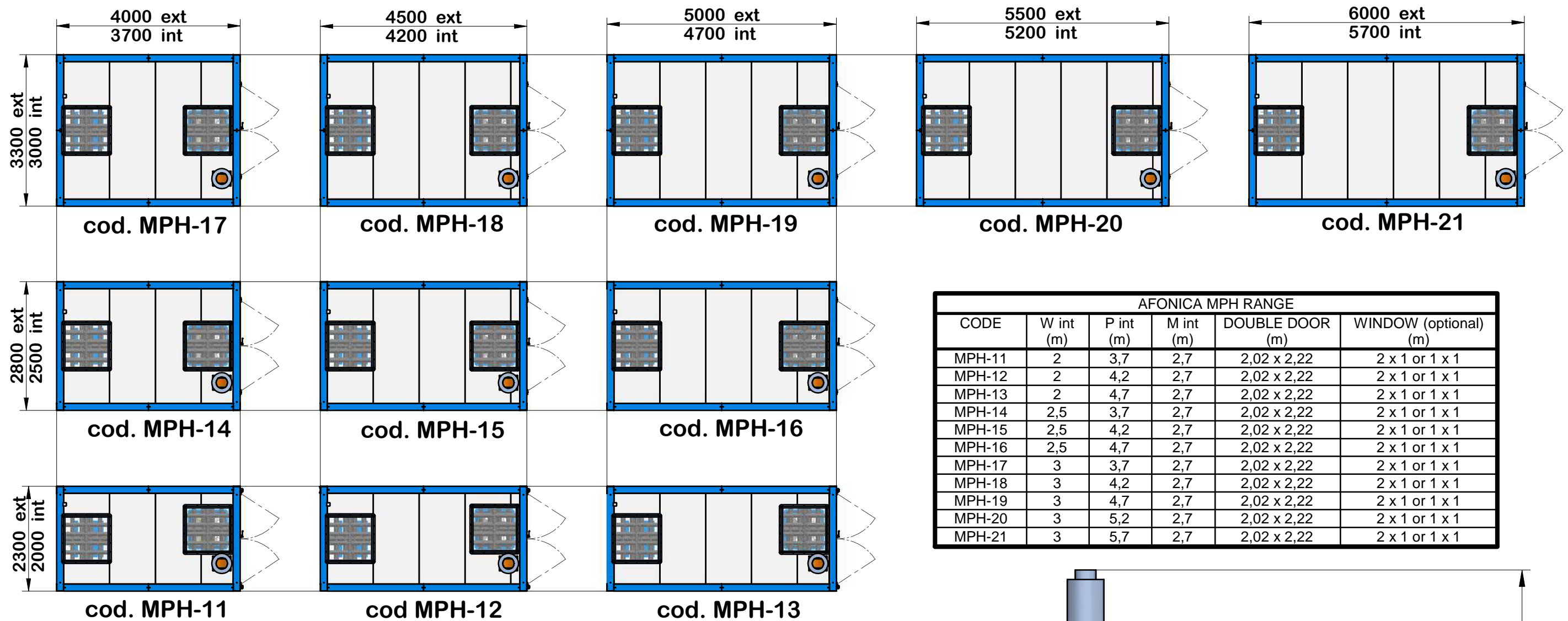

AFONICA MPH RANGE					
CODE	W int (m)	P int (m)	M int (m)	DOUBLE DOOR (m)	WINDOW (optional) (m)
MPH-11	2	3,7	2,7	2,02 x 2,22	2 x 1 or 1 x 1
MPH-12	2	4,2	2,7	2,02 x 2,22	2 x 1 or 1 x 1
MPH-13	2	4,7	2,7	2,02 x 2,22	2 x 1 or 1 x 1
MPH-14	2,5	3,7	2,7	2,02 x 2,22	2 x 1 or 1 x 1
MPH-15	2,5	4,2	2,7	2,02 x 2,22	2 x 1 or 1 x 1
MPH-16	2,5	4,7	2,7	2,02 x 2,22	2 x 1 or 1 x 1
MPH-17	3	3,7	2,7	2,02 x 2,22	2 x 1 or 1 x 1
MPH-18	3	4,2	2,7	2,02 x 2,22	2 x 1 or 1 x 1
MPH-19	3	4,7	2,7	2,02 x 2,22	2 x 1 or 1 x 1
MPH-20	3	5,2	2,7	2,02 x 2,22	2 x 1 or 1 x 1
MPH-21	3	5,7	2,7	2,02 x 2,22	2 x 1 or 1 x 1

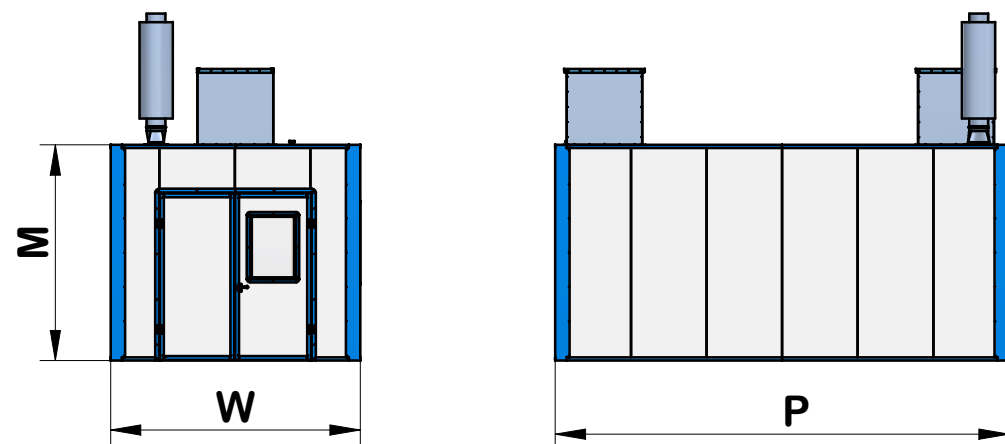

Legenda:
 [W] = Width
 [P] = Depth
 [M] = Medium Height (ext 2,85 m)

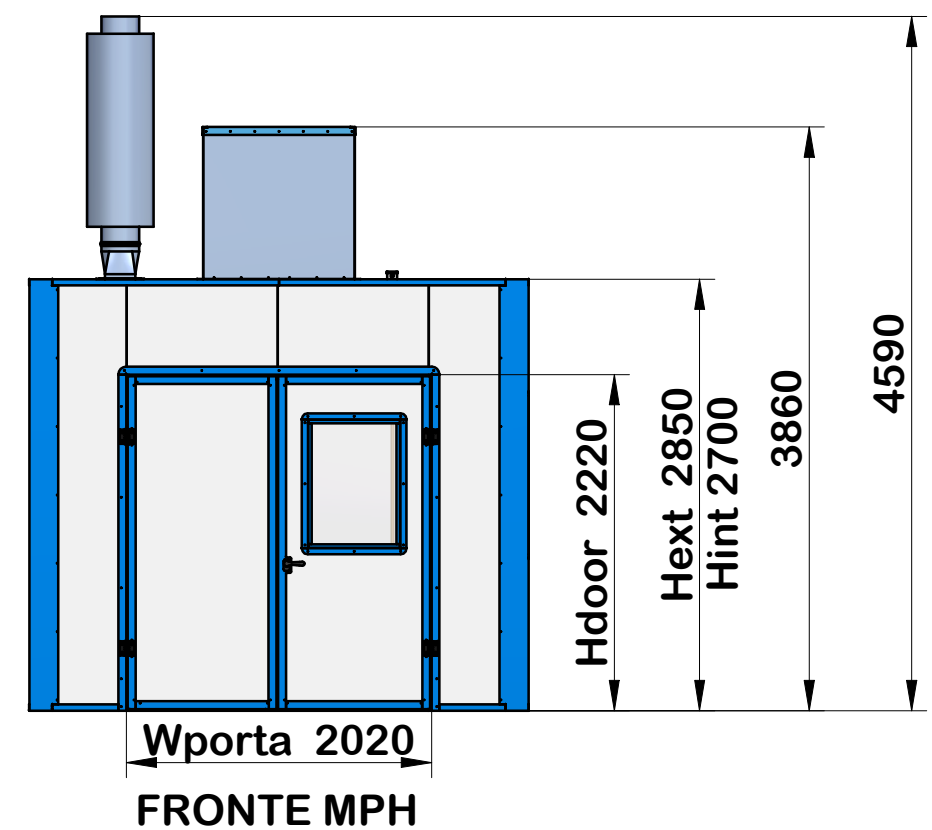

Example Model: MPH-19

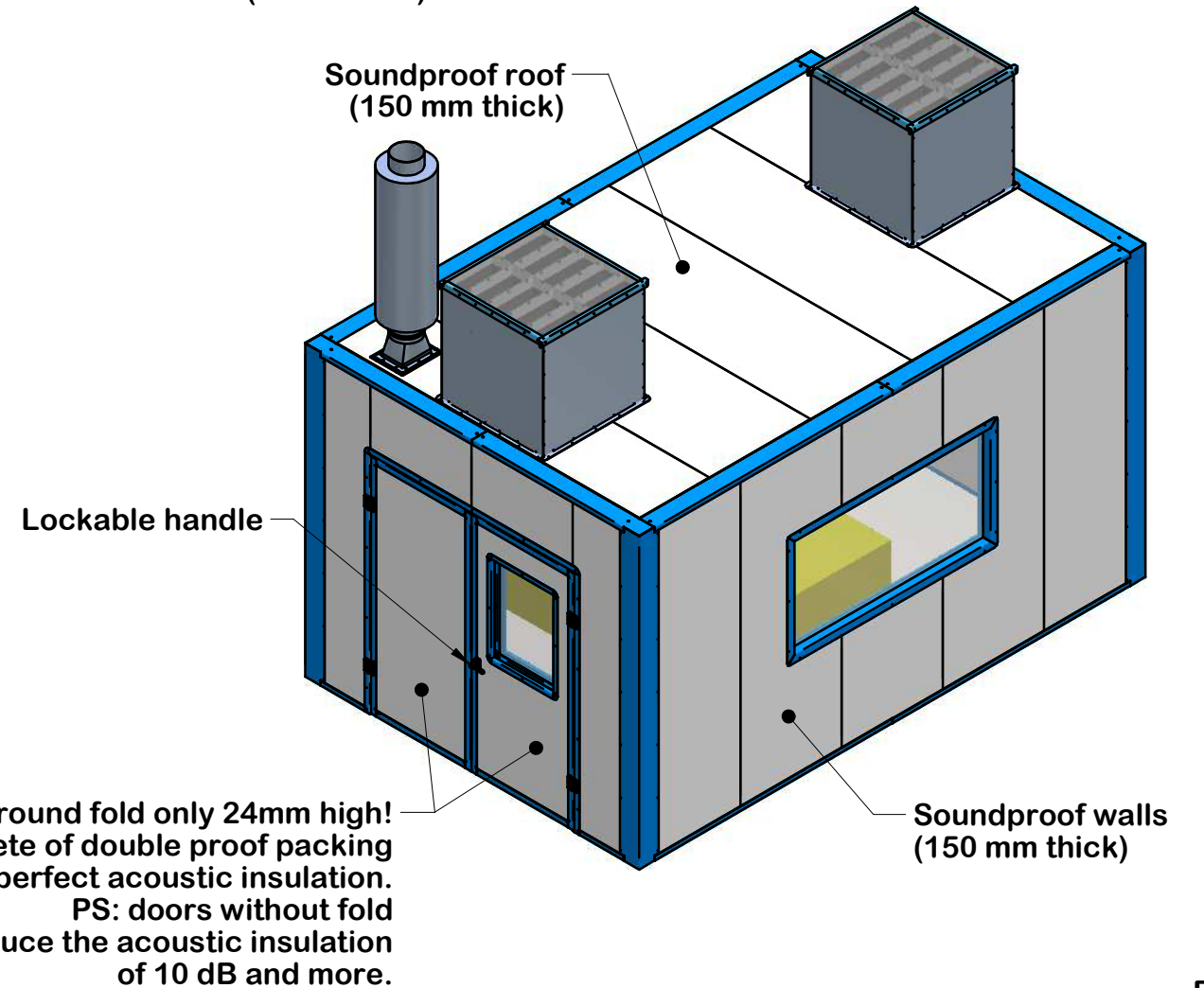
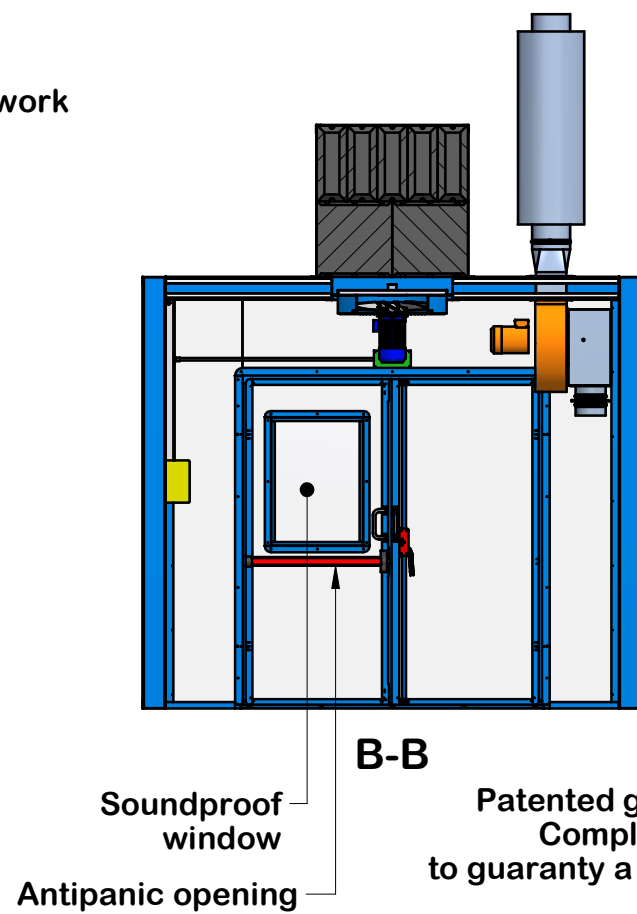
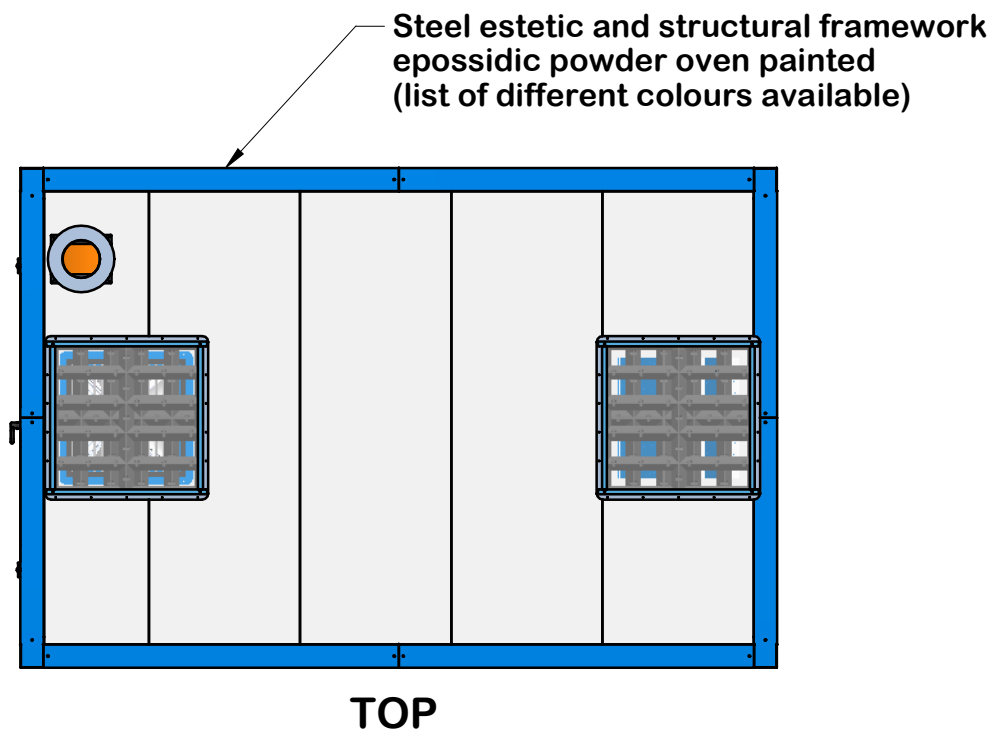
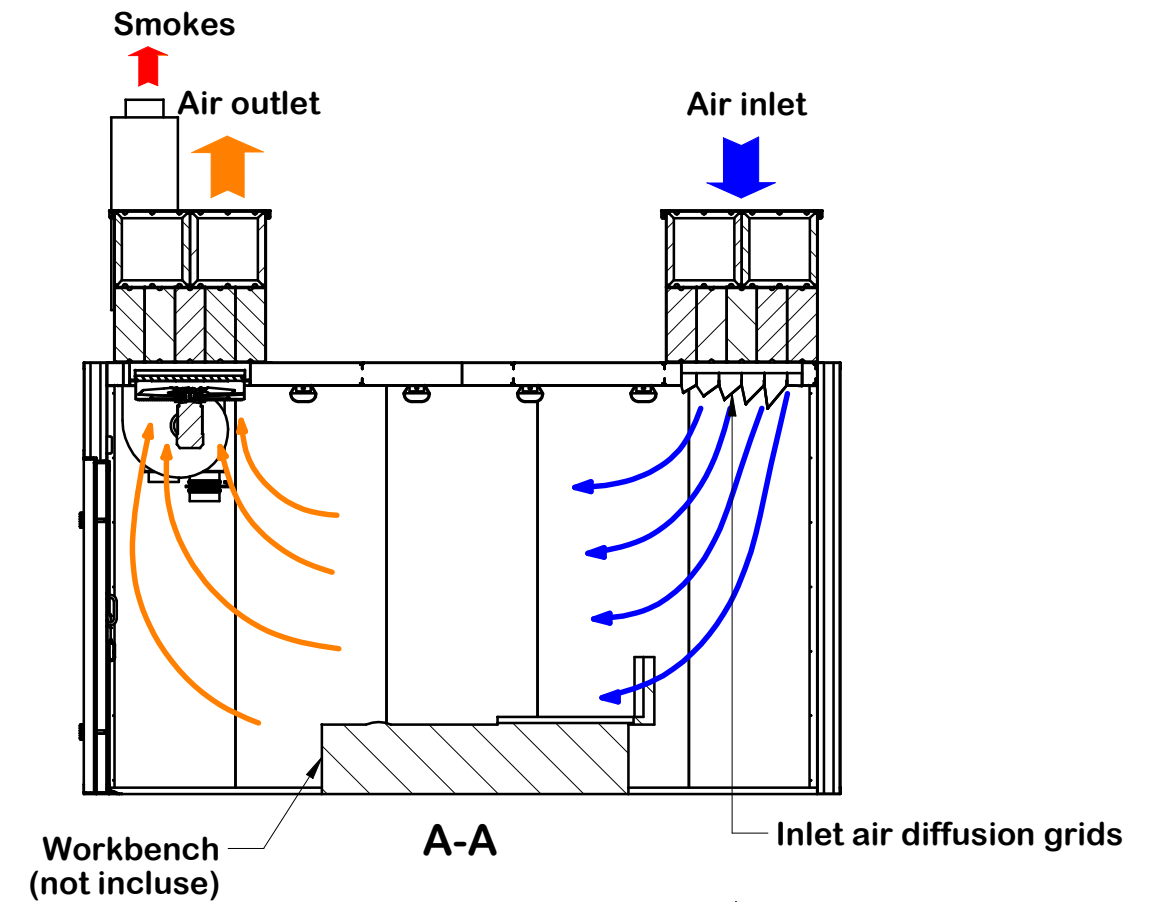
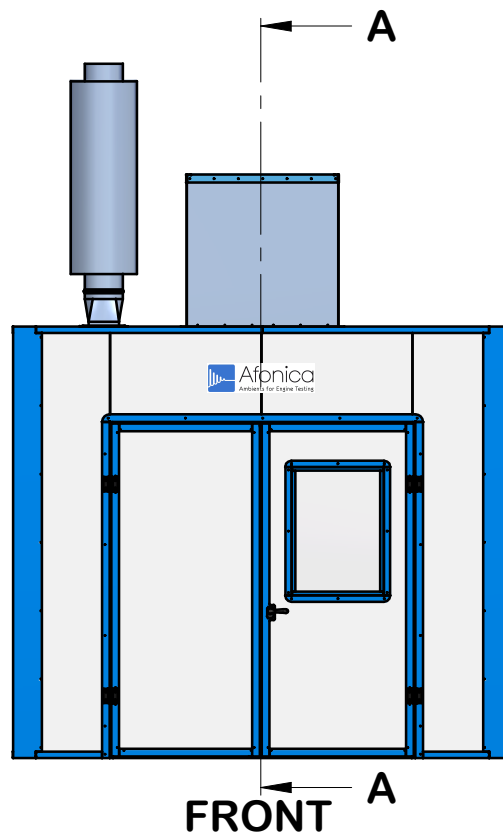
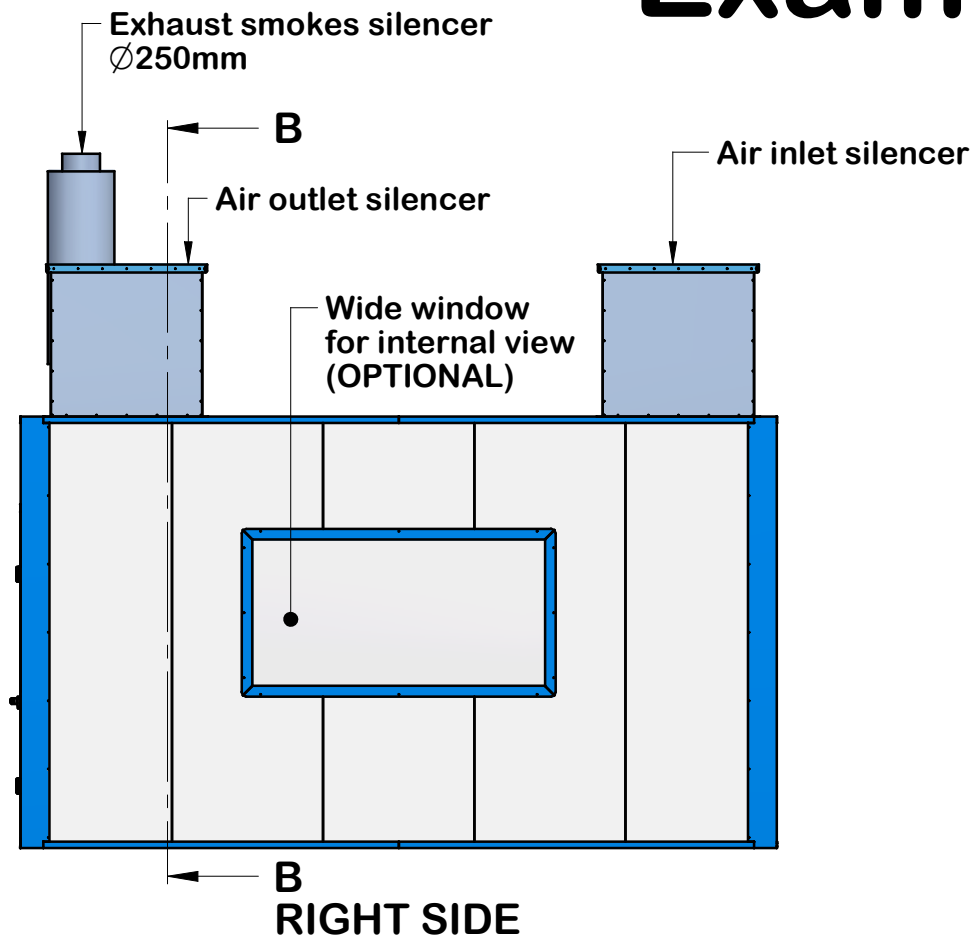

Accessories: Models of SILENCERS

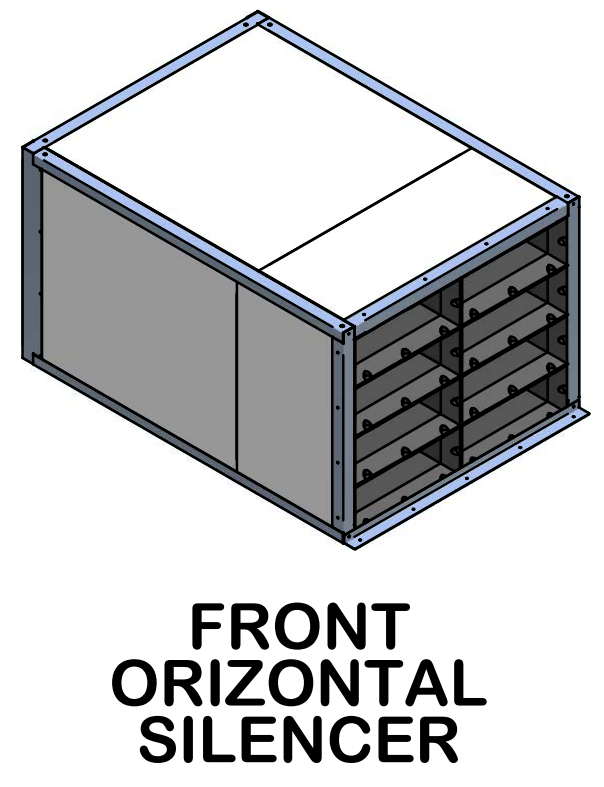
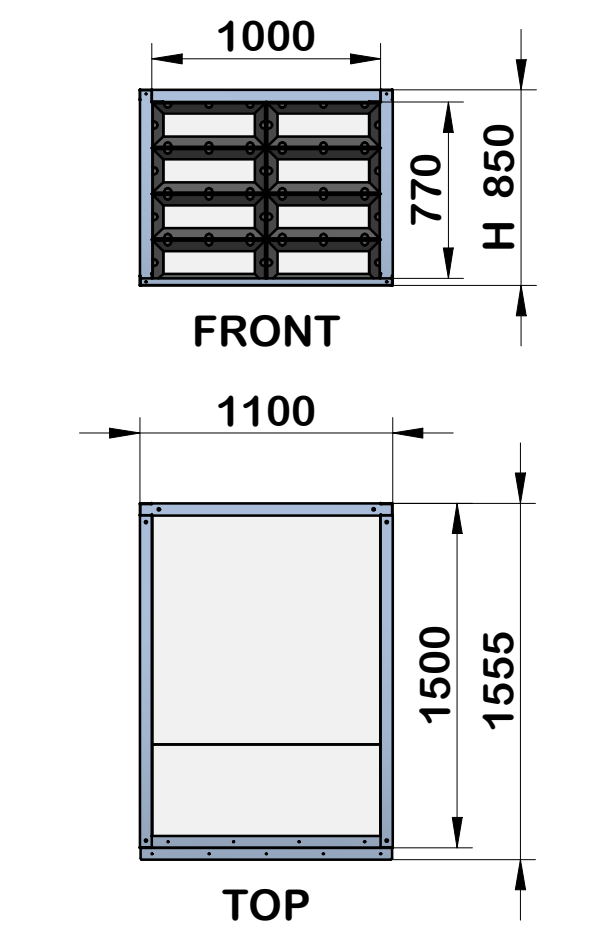
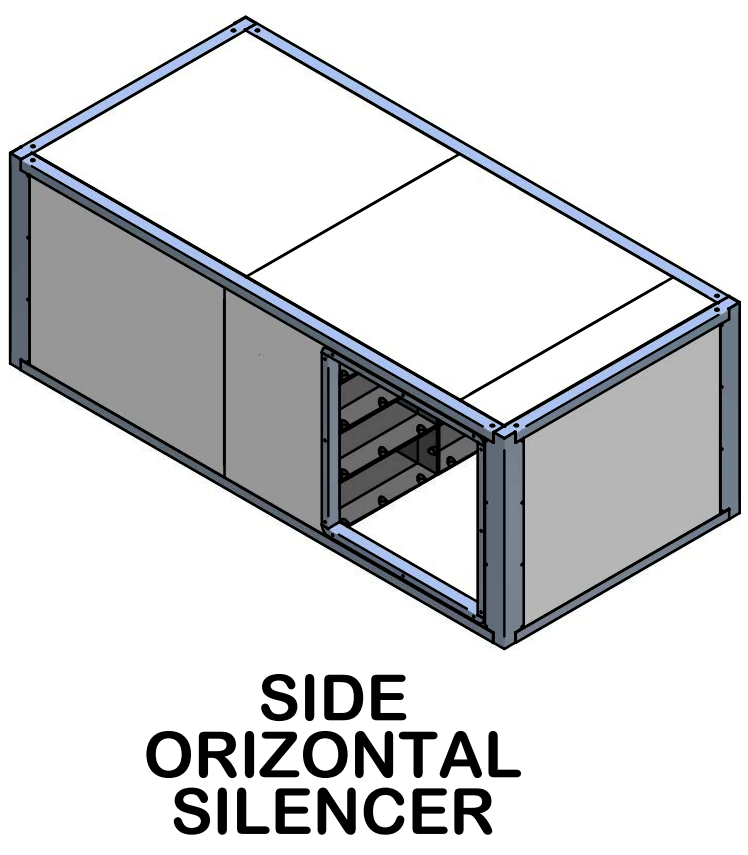
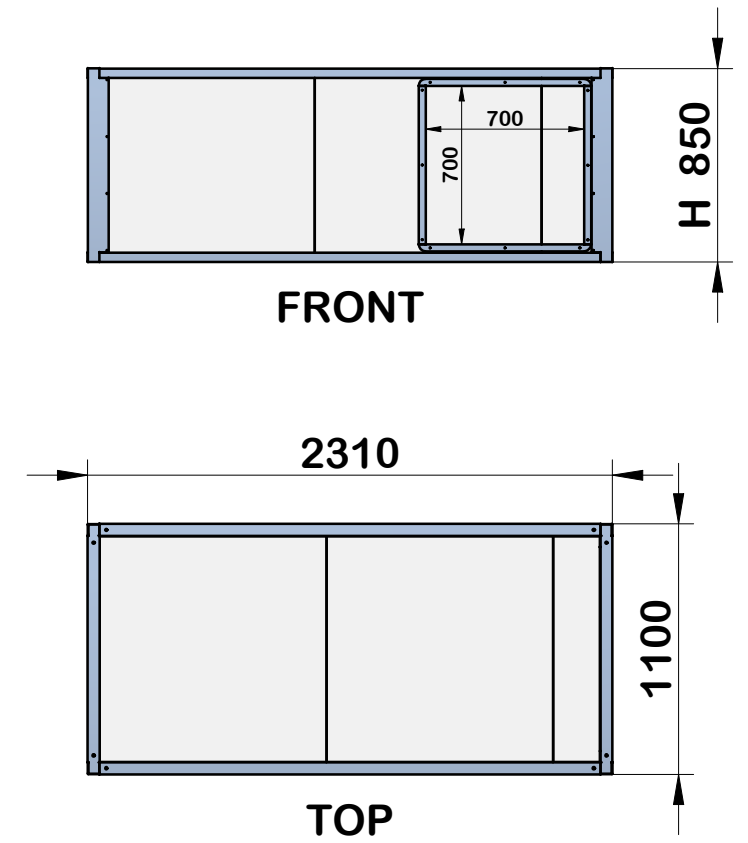
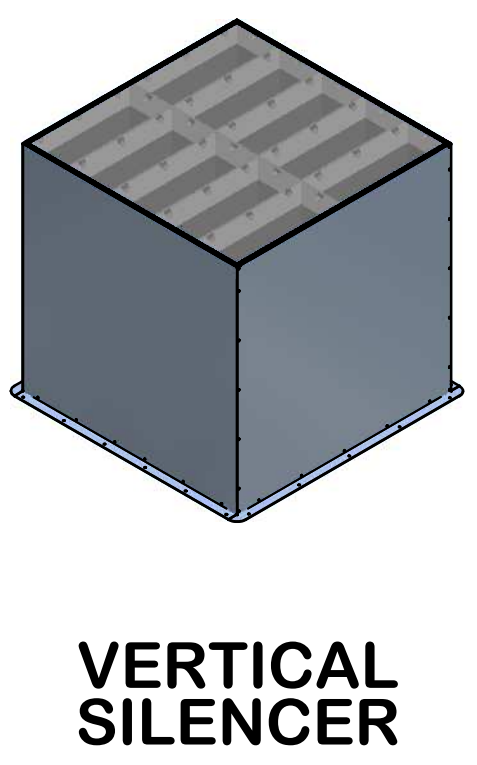
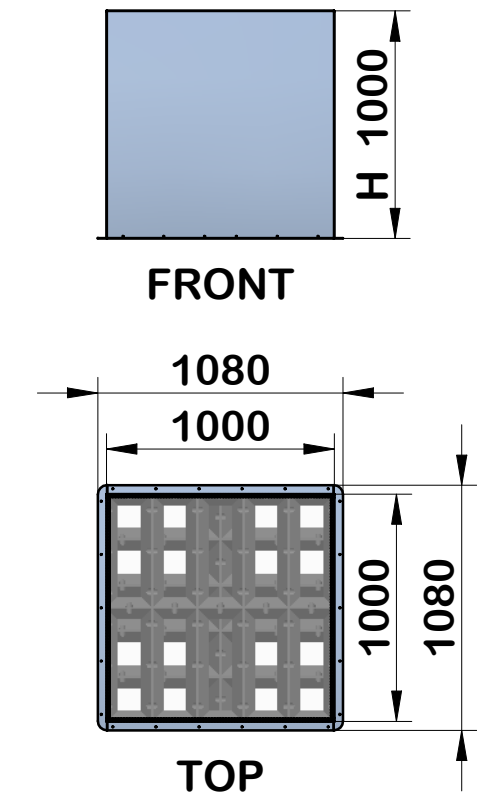

Accessories: WINDOWS (optional)

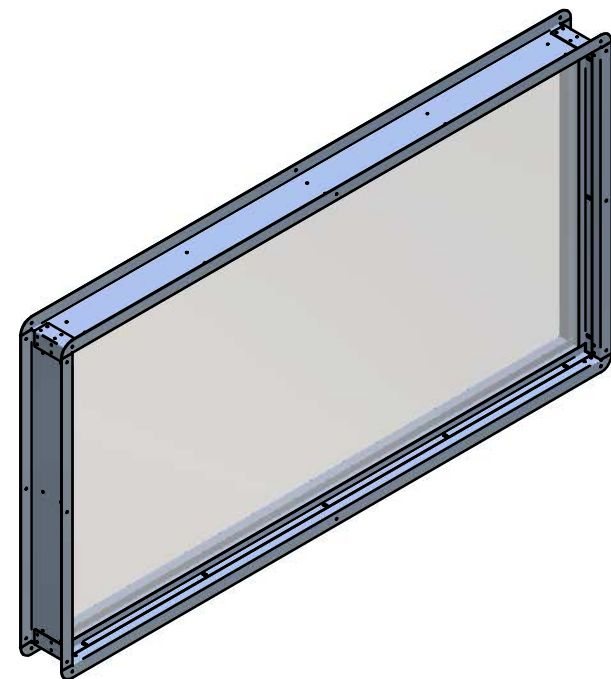
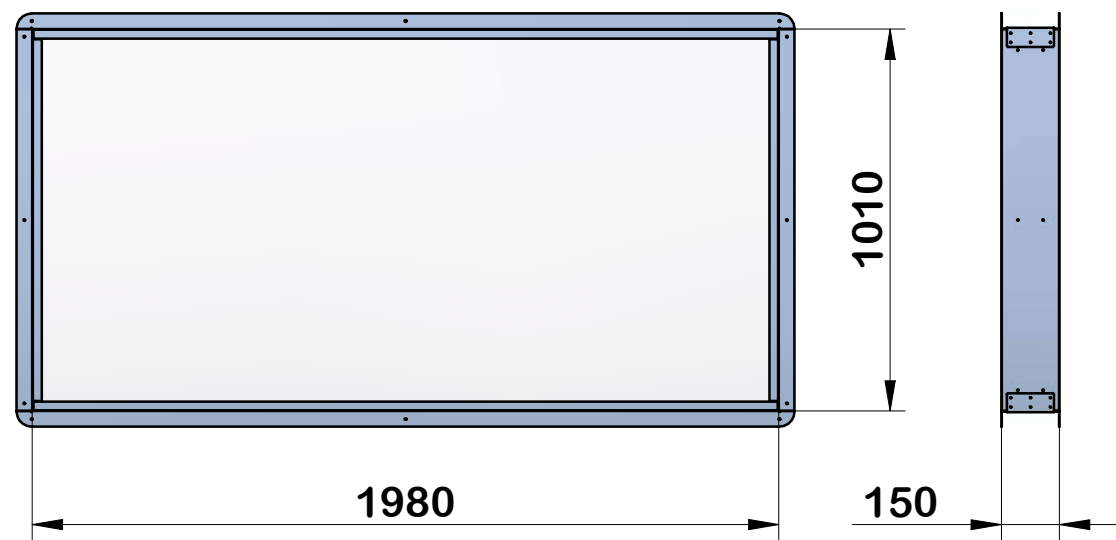

WINDOW
2m x 1m

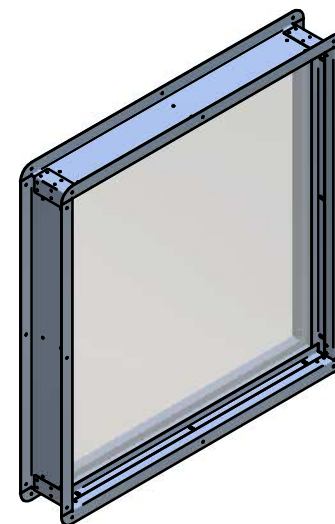
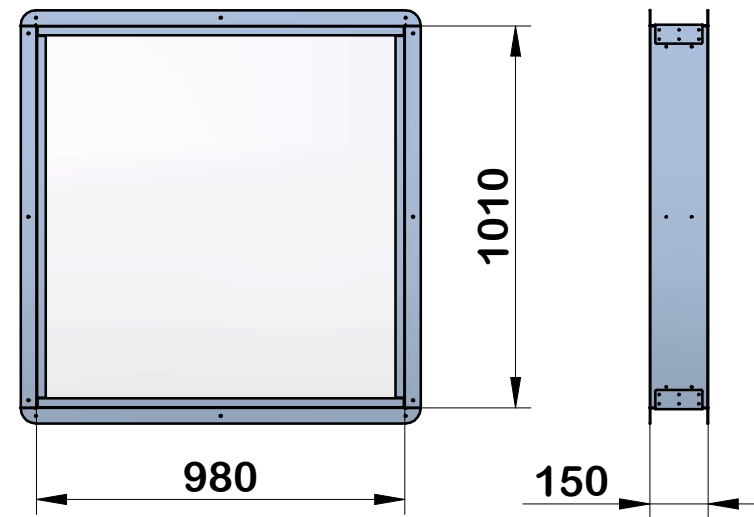

WINDOW
1m x 1m

Accessories*: ELECTRICAL PLANT

(optional)

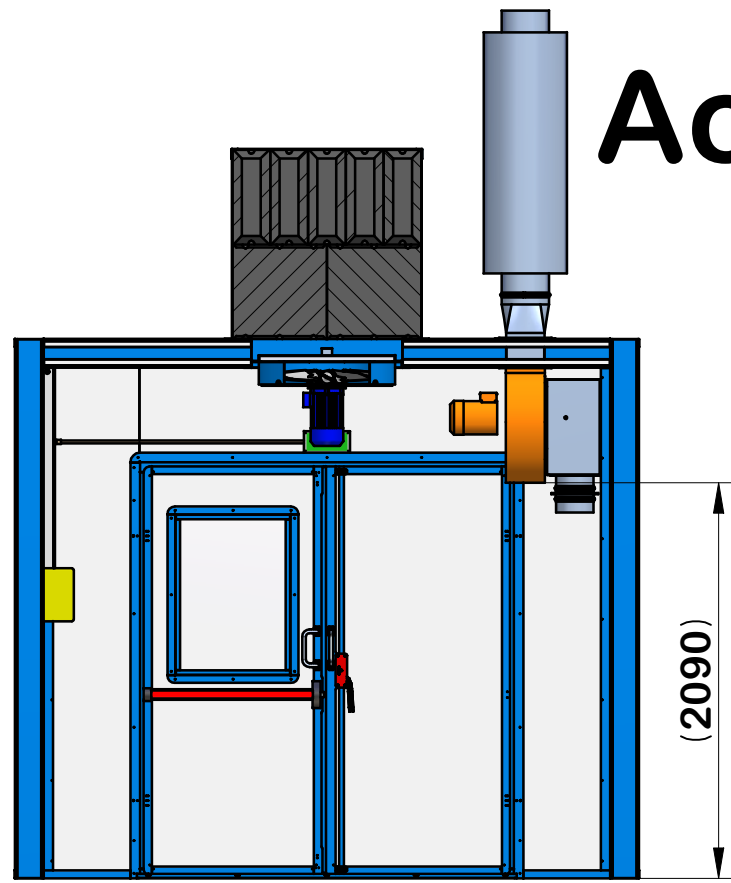

A-A

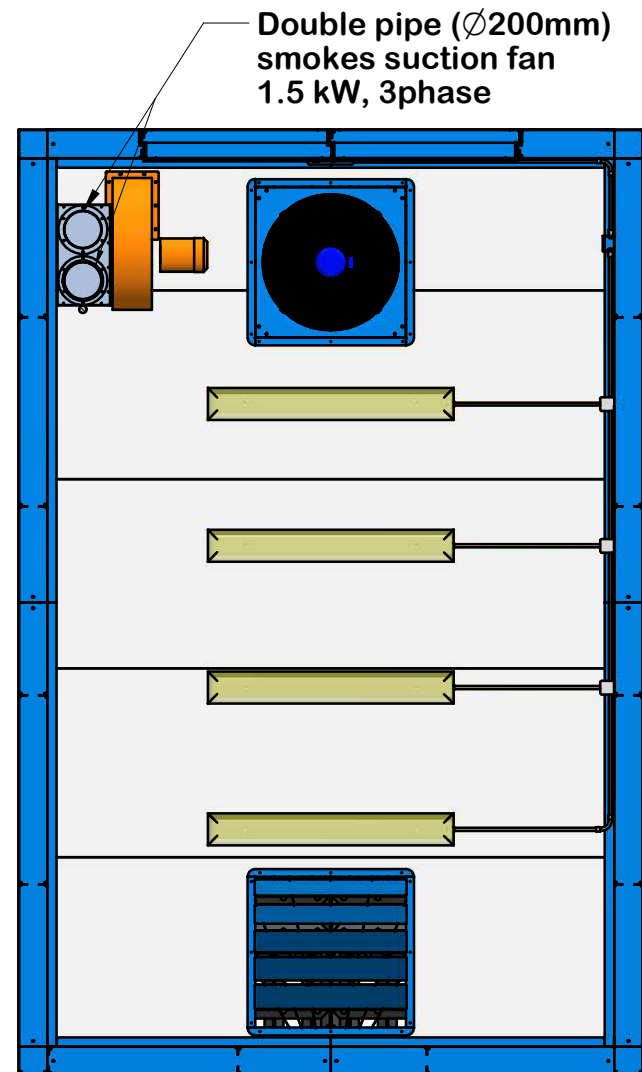
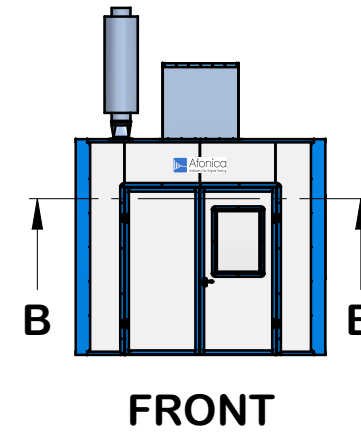
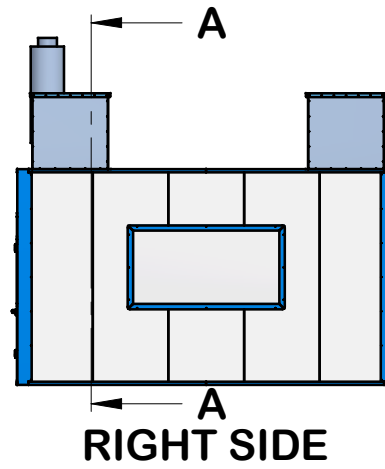
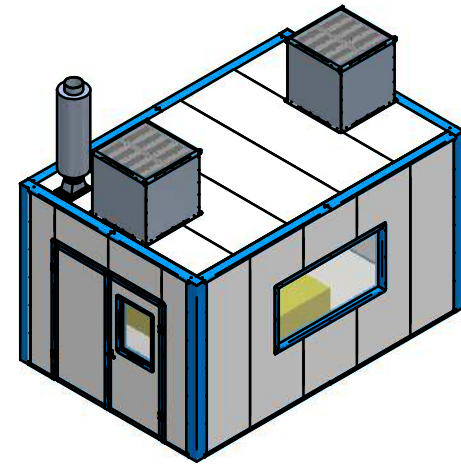

B-B

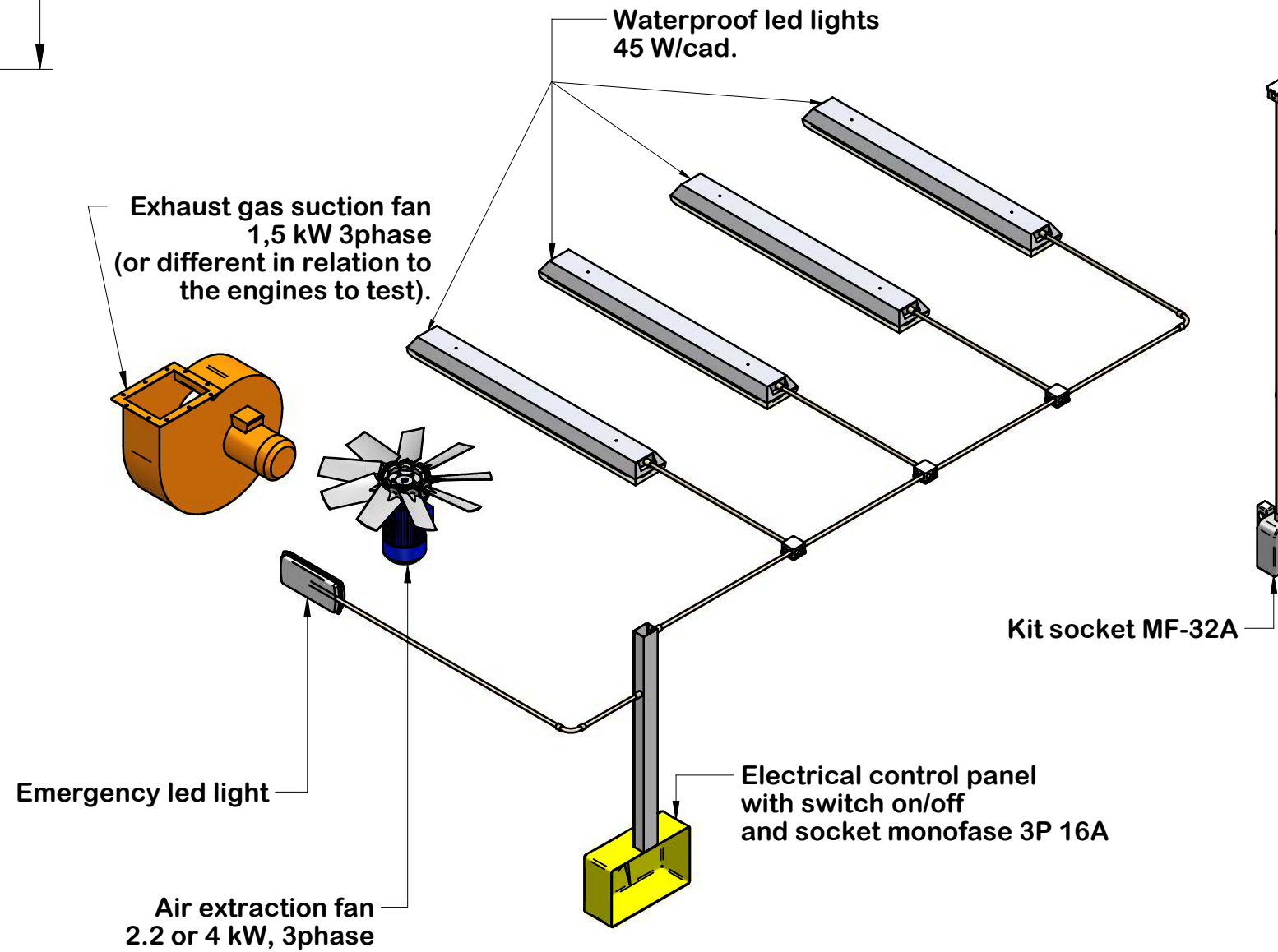

* Available in versione 4.0