

A

B

C

D

E

F

A

B

C

D

E

F

Wide window for internal view:  
soundproof laminated glasses  
in double layer  
NOTE: indifferently settable  
on left or right wall of the chamber

Steel estetic and structural profiles  
epossidic powder oven painted  
(list of different colours available)

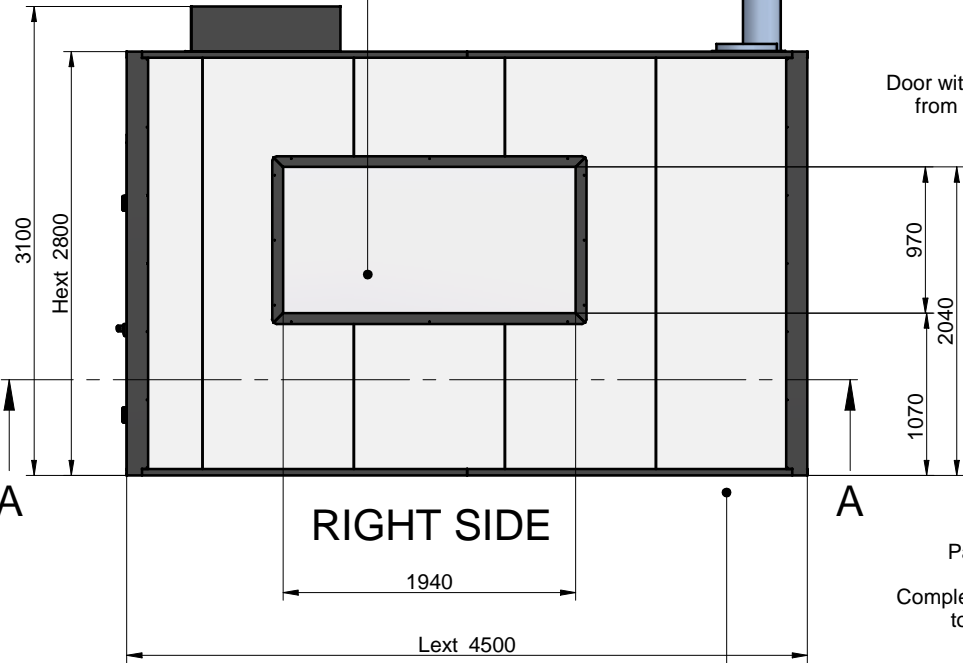

Door with antipanic opening  
from inside and lock with  
key outside

Door with  
manual lock

Patented ground fold  
only 24 mm high!  
Complete of proof packing  
to guaranty a perfect  
acoustic insulation

NOTE: doors without fold  
reduce the  
acoustic insulation of 10 dB and more

Soundproof walls  
(thickness 100 mm)

Soundproof windows

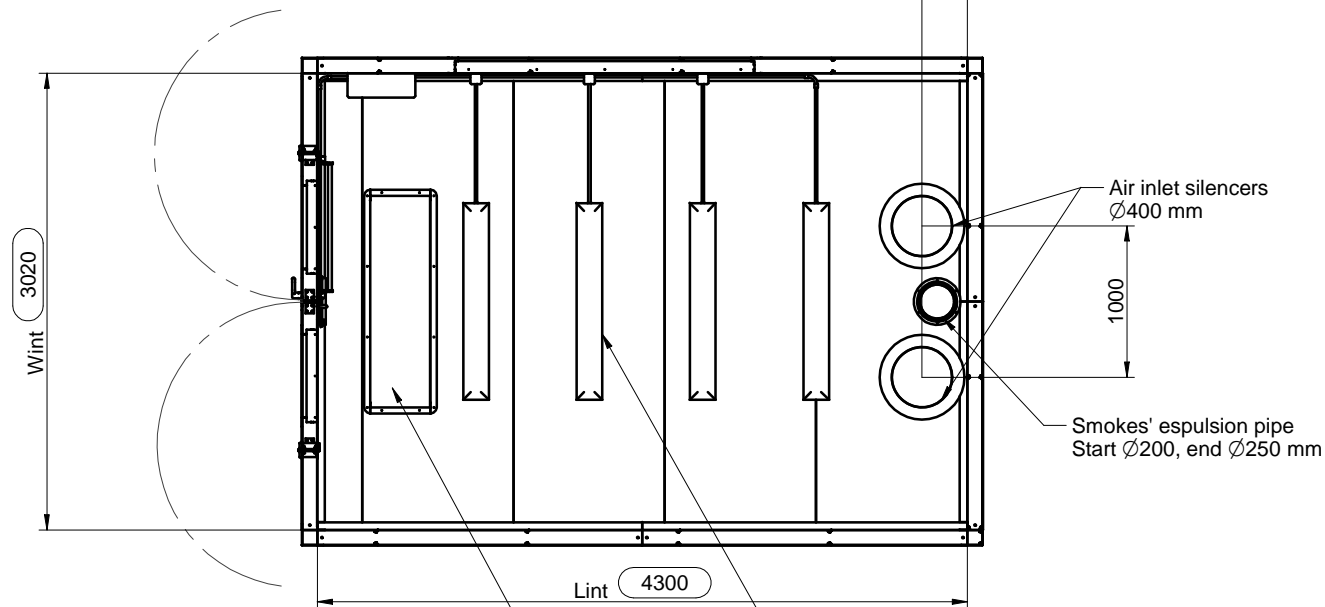
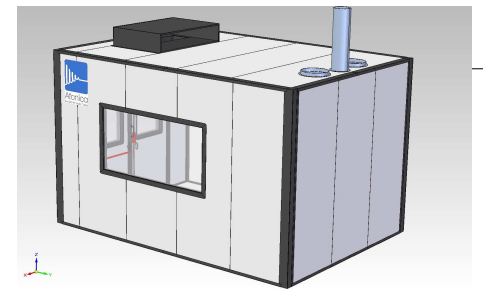
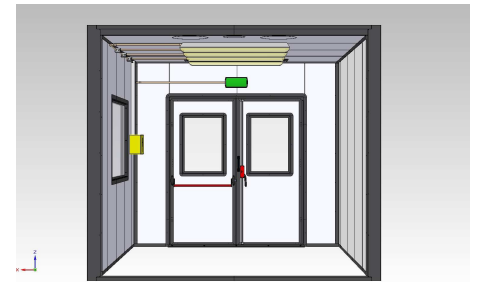
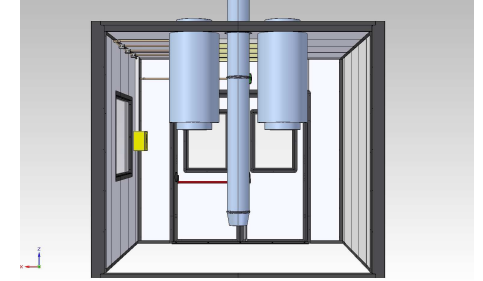
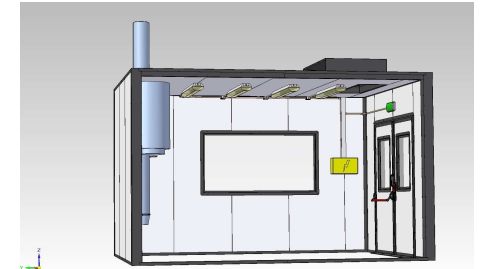
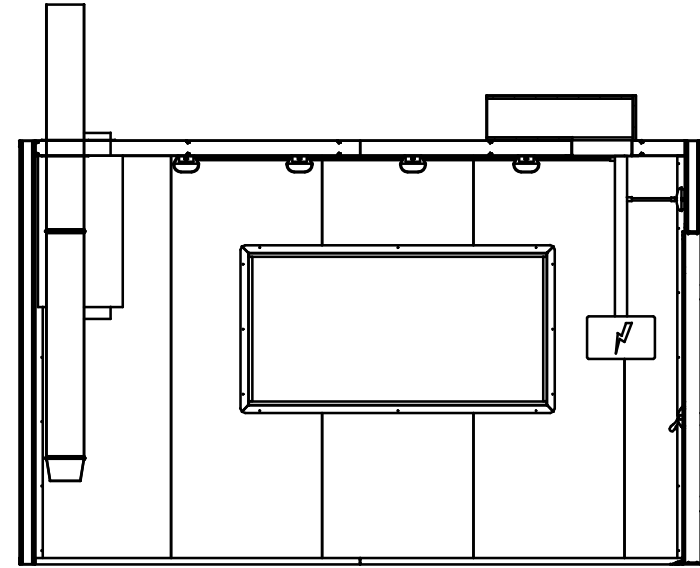
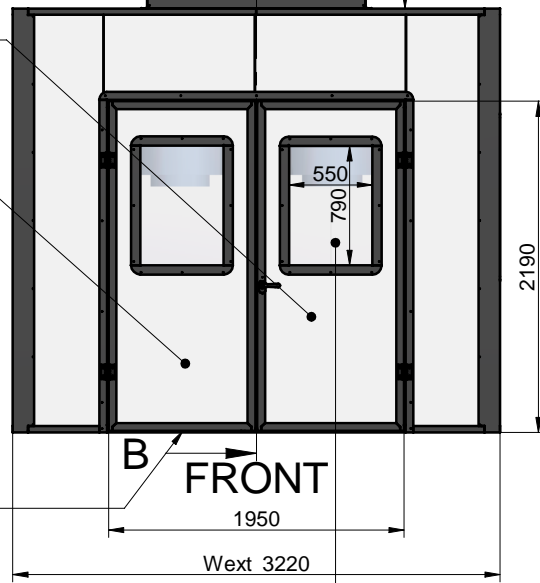

**CERTIFIED ACOUSTIC  
INSULATION: R'w >= 39 dB**

|              |                            |        |            |
|--------------|----------------------------|--------|------------|
| RIF. OFF. N° | ---                        | UNITA' | mm; °      |
| COMMESSA     | ---                        | DATA   | 2016-04-12 |
| TITOLO       | Layout Assembly MPF-433027 |        |            |
| DIS N°       | MPF-433027i2Lf-AM-002-LY00 | REV    |            |
| AUTORE       | DS                         | SCALA  | 1:50       |
|              |                            | SIZE   | A3         |

**Afonica**  
Ambients for Engine Testing

www.afonica.it  
Tel: 0445 397 118  
Fax: 0445 398 078  
E-mail: info@afonica.it

